



BATTISTELLA®

MACCHINE PER STIRARE
IRONING EQUIPMENT

Instructions and maintenance

DIANA

BATTISTELLA B.G. S.r.l.

Via Bessica, 219 36028 Rossano Veneto (VI) ITALY ☎ :
+39-0424-549027 📠 : +39-0424-549007 🌐 : www.battistellag.it ✉ :
info@battistellag.it

This manual is property of BATTISTELLA B.G. S.r.l. We reserve the right to make changes without notice. All rights reserved.

INSTRUCTIONS AND MAINTENANCE

DIANA

**Read this instruction manual very carefully before operating.
 Don't use the machine differently from following description.**

1. SPECIFICATIONS

| | |
|---------------------------|----------------|
| MODEL: | DIANA |
| POWER SUPPLY: | 230 V - 50 Hz. |
| TOTAL INSTALLED POWER: | 1950 W |
| IRON POWER: | 800 W |
| BOILER POWER: | 1150 W |
| BOILER CAPACITY: | 0,8 L. |
| IRONING ENDURANCE: | about 1 hour |
| OPERATING STEAM PRESSURE: | 2,5 BAR |
| WEIGHT: | 4,5 kg. |
| OVERALL DIMENSIONS: | 20x30x19 h. cm |
| MADE IN ITALY | |

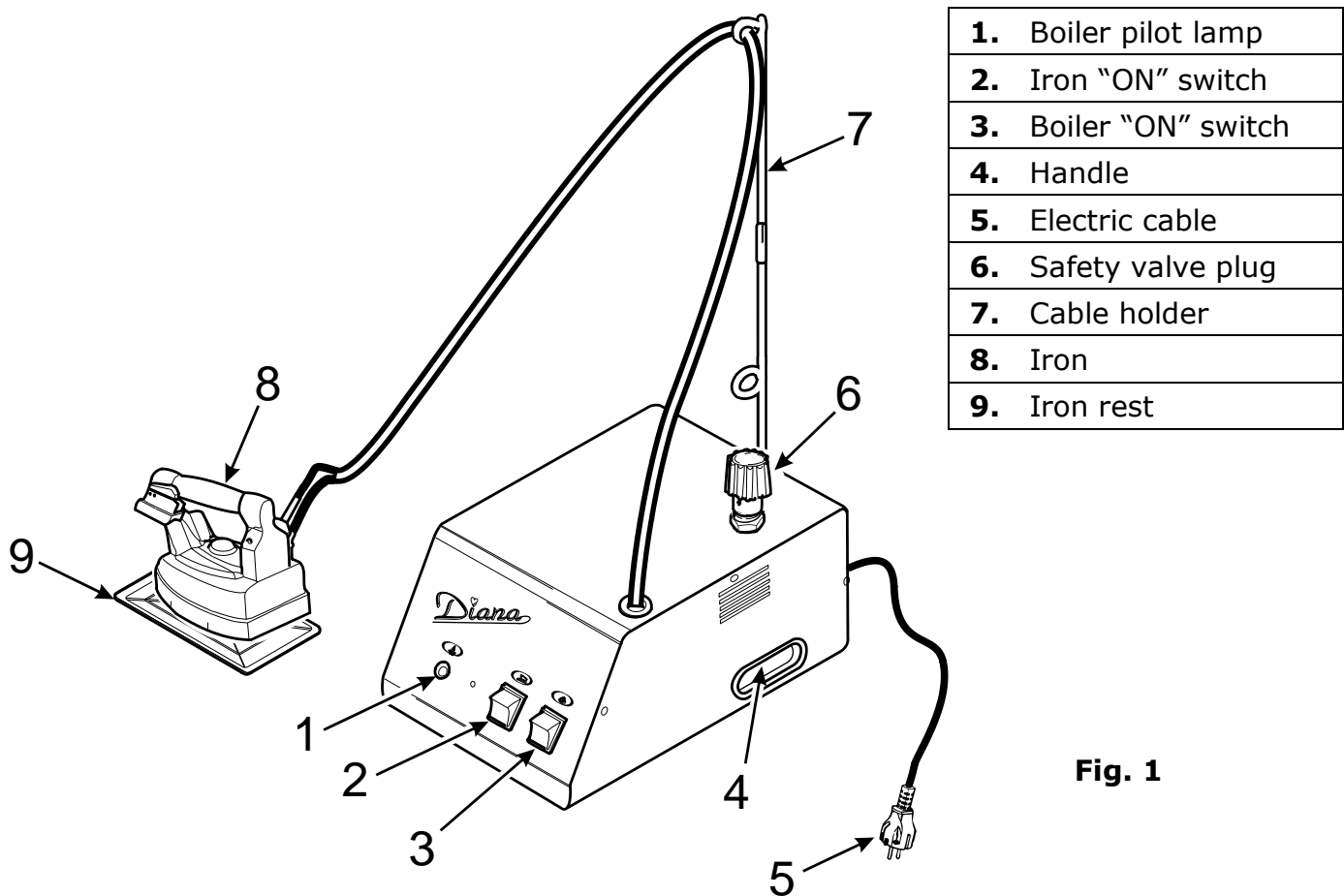

Fig. 1

2. IMPORTANT

Before installing DIANA, it is necessary to set up a protected electrical socket suitable to machine power (it is better to use an earth protector magneto-thermic switch 16 A Id 30 mA).

For the transport and the movement of DIANA, take the generator only by the specific handles. Never pull the electric wires (fig. 1).

This steam generator is not suitable for people (children included) with physical or mental handicaps or inexperienced persons, unless they are instructed by a person who takes the responsibility for their safety. Children must not play with the steam generator.

3. OPENING OF PACKAGE

1. Open the box containing DIANA take the instructions manual and read it carefully.
2. Remove DIANA from the box, assemble the cable support and insert it deep into the special support holder (fig. 1) placed on the back of the generator.
3. Fix the cable and the tube of the iron to the support hook, avoiding entwining (fig. 1).
4. Place the iron on the rubber iron rest supplied with the machine (fig. 1).

4. CONNECTION AND STARTING

With DIANA switched off and disconnected plug:

1. Unscrew the safety valve plug of DIANA (fig. 1), fill the boiler with water to the desired level paying attention not to overfill it. It is advisable to use a funnel. Take the plug by the plastic part and screw it again: do not tighten too much or its gasket might get spoilt (see section 7).
2. Insert the plug into a 230 V 16 A socket.
3. Switch on the boiler and the iron switch and adjust the thermostat of the iron (fig. 2) on "cotton".
4. Wait for the boiler lamp to switch off. At this point seize the iron by cork handle and press the micro-switch of the iron (fig. 3) 4 or 5 times, so that steam comes out. It is important to make sure that the steam is saturated (by pressing the micro-switch with the iron pointed towards the floor). Now everything is ready for ironing. During ironing operation, the boiler lamp switches on and off signalling that the machine is working properly.

5. GENERAL WARNINGS

1. Connect DIANA to a suitable and protected socket (avoid connecting the device to multiple sockets or extensions which are not suitable to its power).
2. Keep children away from DIANA, both when it is on and off.
3. Place the equipment on a steady surface, whether it is being used or not.
4. Always place equipment horizontally when it is being used.
5. The operator must never leave the machine unattended when it is switched on.
6. Use only drinkable water coming from the water supply for domestic use.
7. Never add any sort of additives to water.
8. Never empty the boiler while it is working (see section 8).

9. Never unscrew the safety valve plug while machine is being used.
10. **Never replace the safety valve plug (fig. 1) with other types of plug. N.B. the safety valve plug is set at 4,5 bar and it has the function of a safety valve.**
11. Never leave the iron on the board or on garments when it is on.
12. Never place the iron directly on the metal part of the iron rest (always use the proper rubber rest).
13. Do not iron garments directly on persons or things.
14. When in use, do not bring the machine near inflammable or thermo-labile parts.

6. IRONING

1. Run the iron on garments, pressing the micro-switch of the iron at intervals (fig. 3), so that steam comes out.
2. For delicate, blue or black garments, we suggest to use the specific anti-sheen shoe.
3. During ironing operation, always put the iron on its rubber rest (fig. 1).
4. For dry ironing it is possible to adjust the thermostat (fig. 2) on different positions according to the type of fabric (look at garment label). For steam ironing set the thermostat on "cotton" or "linen" " (**N.B.:** the thermostat of TULIPANO irons must be set between "wool" and "cotton").
5. When the machine is used with a non-vacuum board, some circular water spots might form. In this case, reduce the use of steam. It is recommended to combine the machine with a vacuum and heated ironing board.

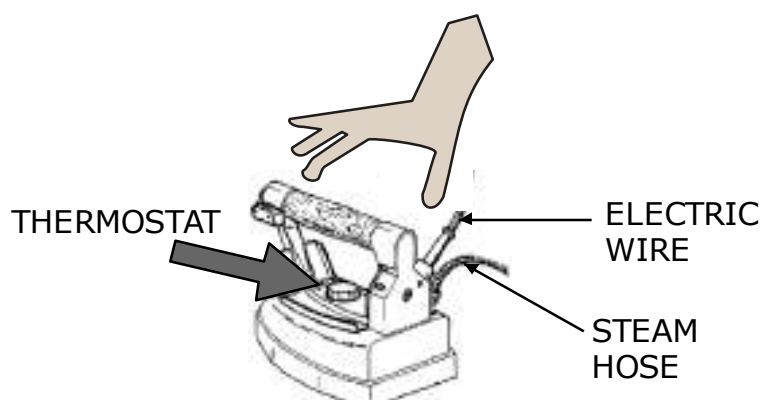

Fig. 2

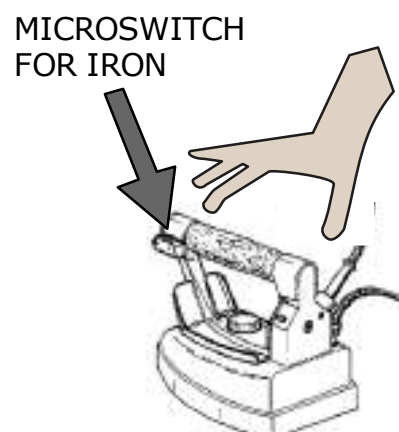

Fig. 3

7. WATER FILLING

During the ironing, if steam flux decreases considerably and then ends definitely, it means that there is no more water in the boiler.

At this point disconnect the plug, rotate the valve plug (fig. 1) of 360° and wait for steam to go out completely. Unscrew the valve plug with care and wait 5/10 minutes.

Then fill the boiler up to the desired level (fig. 1) paying attention not to overfill it (see section 4 point 1). Screw the safety valve plug again, connect the plug and wait for the boiler lamp to switch off. Now the iron is ready again.

While refilling the boiler, do not spill water onto the machine. In the event this should happen, dry immediately in order to avoid electrical risks.

8. BOILER DISCHARGE

Empty the boiler periodically. Carry out this operation when the DIANA is turned off, cold and the plug disconnected. Wait at least 1 hour after the switching off. During this procedure, wear proper gloves in order to avoid accidental burns.

Unscrew the safety valve plug (fig. 1) and rotate the DIANA rightwards so that water and possible impurities come out.

9. GOOD FUNCTIONING

DIANA was designed and manufactured for the ironing of domestic garments. It can be used maximum 10 hrs. per week (subdivided in many times) or 40 hrs. per month.

10. INTERVENTIONS AND SMALL REPAIRS

1. It is advisable to empty the boiler every 2-3 times you use it.
2. Replace the gasket of safety valve plug (use only original gaskets) every 1200 hrs. of lighting or maximum every 2 years, or earlier if it is damaged. Carry out this operation when the machine is switched off and cold.
3. If the electric wire is damaged, replace it immediately. The wire is supplied by the manufacturer or authorized service centres.

11. COMPULSORY PERIODICAL MAINTENANCE

(To be carried out exclusively by assistance centres or by the manufacturer)

It is recommended to replace:

1. the internal safety valve every 1400 hrs. of ironing or maximum every 3 years;
2. the internal thermostats every 1400 hrs. of ironing or maximum every 3 years;
3. steam tube and iron cable once they seem damaged (fig. 3);
4. the safety valve plug every 2500 hrs. or maximum every 3 years (fig. 1).

It is recommended also to clean the boiler from limestone every 1400 hrs. of ironing or max. every 3 years.

12. ELECTRICAL RISKS

The following situations are considered dangerous for the operator:

1. earth protector switch is activated when turning on the machine;
2. using DIANA during thunderstorms;
3. using DIANA without proper protection for feet (without shoes...) or with wet feet;
4. damaged electrical wires;
5. when the electric wire touches hot parts of the machine;
6. iron overheating or loss of water from the iron (fig 2);
7. washing or cleaning the iron using water (fig. 2);
8. loss of water from the machine;
9. filling the boiler when the machines is switched on.

13. MECHANICAL RISKS

The following situations are considered dangerous for the operator:

1. using DIANA for different purposes other than ironing;
2. replacing the gasket of the safety valve plug with non-original gaskets.

14. THERMIC RISKS

The machine can become extremely hot: use it very carefully and disconnect the plug when not in use.

The following situations are considered dangerous for the operator:

1. touching iron base when it is hot;
2. emptying the boiler under pressure;
3. touching the safety valve plug when the machine is under pressure;
4. directing the steam jet towards people or animals.

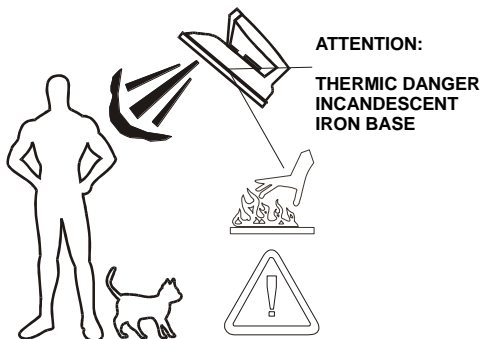

- Do not iron garments directly on persons.**
- Do not leave the iron on garments when it is on.**
- After use, always put iron on its rubber rest.**

15. PACKING, STORAGE AND TRANSPORT

DIANA is packed in cardboard box which cannot be turned upside down. It is not a stiff package, therefore is not shock-resistant. We advise you to handle the box with utmost care and do not use it as a stool or support.

For authorized distributors and resellers: do not store more than 3 boxes one on top of another and keep them dry (Handle with care).

16. WARRANTY

The manufacturer's warranty becomes void:

- in the event of repairs carried out by unauthorized personnel or service centers;
- total or partial failure to follow the instructions contained in this manual;
- for poor storage, lack of maintenance/cleaning or incorrect assembly;
- when there are damages caused by the customer;
- when there are failures or damages that do not derive from a manufacturing defect;
- when there are damages deriving from a fortuitous event (fire, short circuit) or due to third parties (tampering);
- when there are damages caused by limescale;
- when the damage has been caused by the use of water different from that indicated in the instructions (see "WATER CONNECTION" chapter);

- when using the machine for a purpose different than the one specified in this manual;
- when using non-genuine spare parts or accessories, modified or not suitable for the appliance.

17. DISPOSAL



According to the directive 2012/19/UE on waste of electrical and electronic equipment, do not treat this product as household waste.

This appliance is marked according to the directive 2011/65/UE on restriction of use of specific dangerous substances in electrical and electronic equipment.

This symbol on the product or on its packaging indicates that this product shall not be treated as household waste. Instead it shall be handed over to the applicable collection point for the recycling of electrical and

electronic equipment.

Ensuring this product is disposed of correctly will help prevent potential negative consequences for the environment and human health which could otherwise be caused by inappropriate waste handling of this product. The recycling of materials will help to conserve natural resources.

The abusive disposal of the product by the user may lead to administrative sanctions.

~~~~~

### Every product manufactured by **BATTISTELLA B.G. S.r.l.** is subject to the following limitations:

- ❖ **BATTISTELLA B.G. S.r.l.** assures that this machine, correctly installed and used, works according to this instruction handbook. Each implicit warranty is limited by law as from purchase date.
- ❖ **Declination of responsibility for consequential damages: BATTISTELLA B.G. S.r.l.** will never take the responsibility for any damage (included, without any limitation, consequential damages due to loss or no profit, cutback or any other economical loss) deriving from the use of a BATTISTELLA machine, even in case the Company had been previously informed of such possibility.

Should you need **further information** about this instruction handbook, please contact **BATTISTELLA B.G. S.r.l.** or the person who sold you the machine.

~~~~~